

WTO

nanoFlex[®]

Il nuovo Sistema modulare a cambio rapido.
Disegno compatto e di alta precisione.

Minimo investimento ma grande espandibilità.

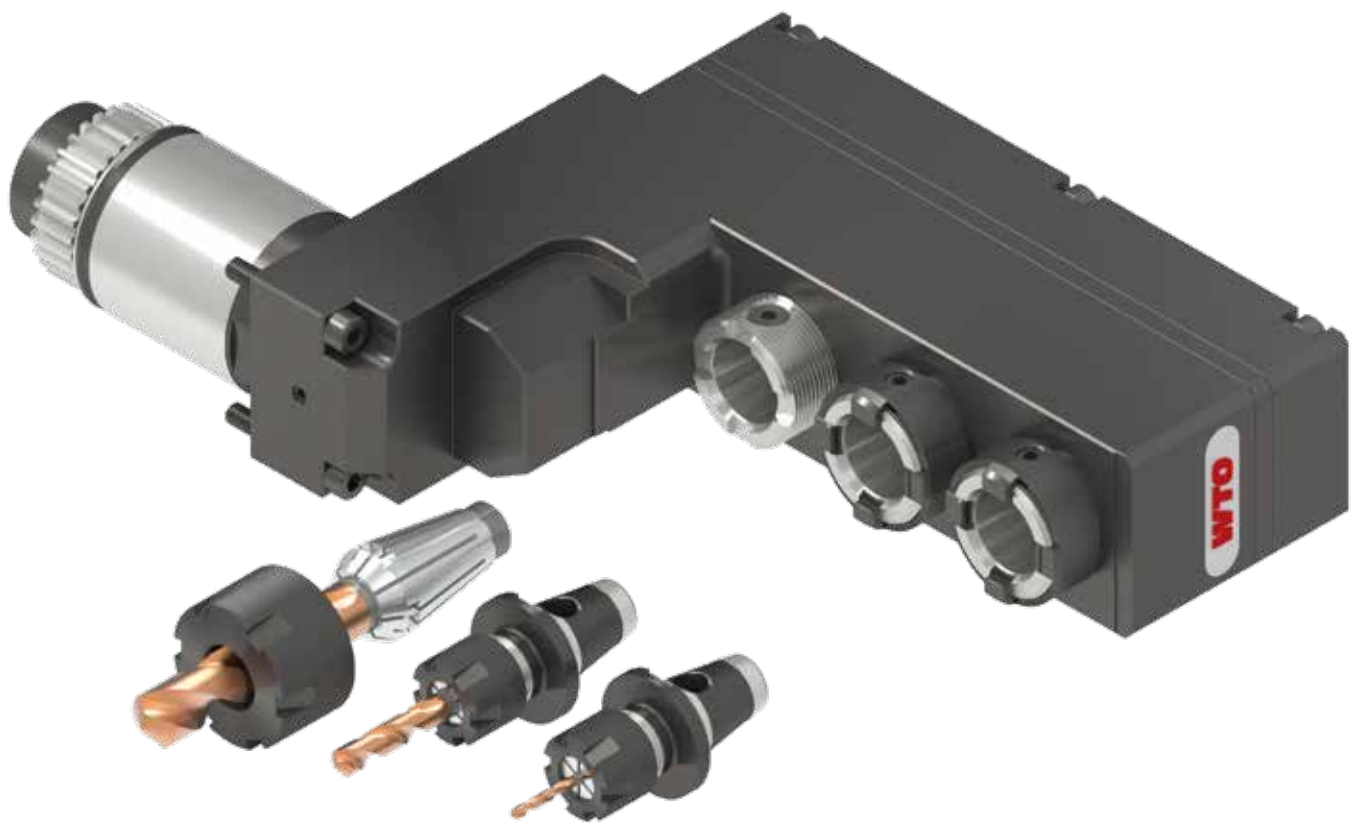

Ideale
per
torni a fantina
(Swiss Type)

nanoFlex®

La perfetta combinazione: mandrino con pinza ER e adattatori a cambio rapido in un unico porta utensili.

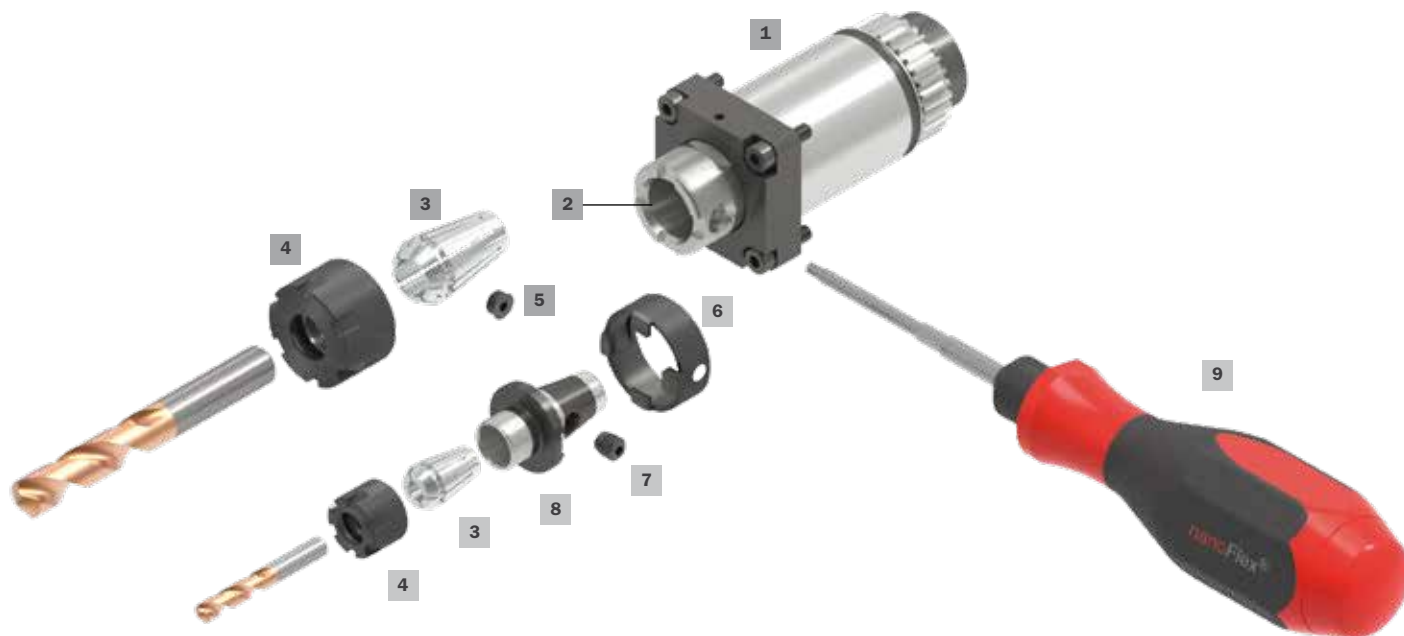

Mandrino equipaggiato per adattatori nanoFlex®.

- 1 - Porta utensili
- 2 - Mandrino nanoFlex®
- 3 - Pinza ER
- 4 - Ghiera
- 5 - Tappo a vite per lato mandrino
- 6 - Anello di trascinamento per la trasmissione della coppia per gli adattatori a cambio rapido nanoFlex®
- 7 - Vite di bloccaggio adattatori nanoFlex®
- 8 - Adattatore a cambio rapido nanoFlex®
- 9 - Chiave con valore di coppia impostata per bloccare e sbloccare gli adattatori a cambio rapido nanoflex.
- 10 - Incastri nel mandrino per trasmettere la coppia
- 11 - Cono per pinze ER e adattatori



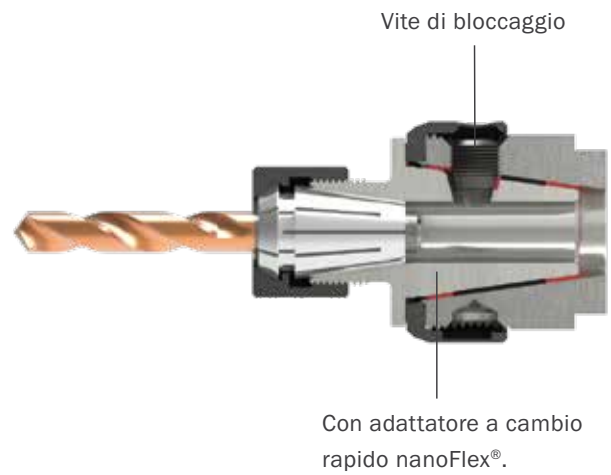
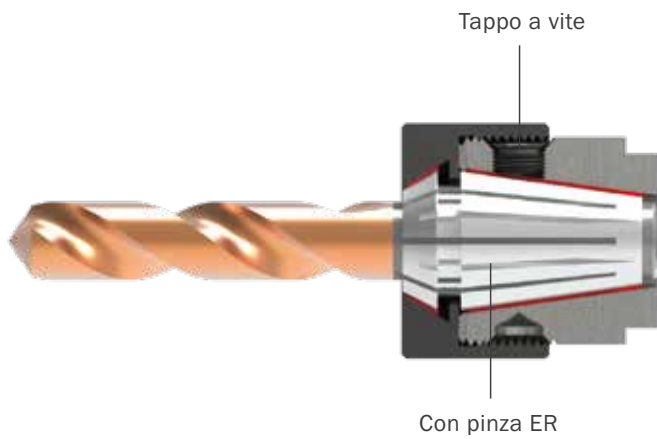

Modo di bloccare la ghiera per pinze ER.

Modo di bloccare gli adattatori a cambio rapido nanoFlex®



Montaggio per utilizzare gli adattatori a cambio rapido

Preparazione



Bloccaggio e sbloccaggio degli adattatori

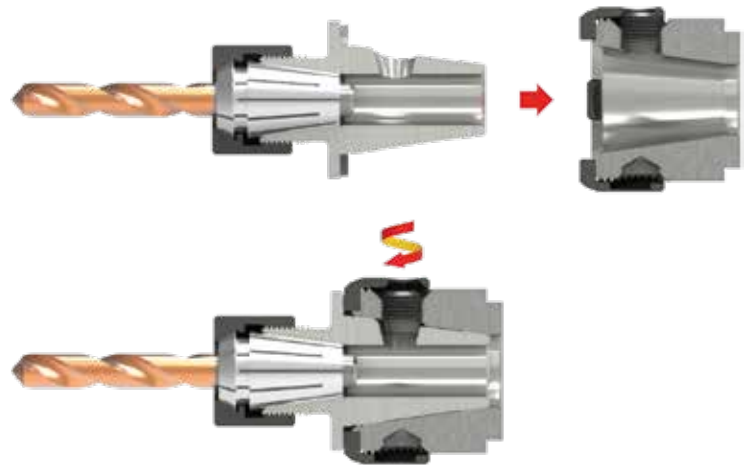

Montaggio utilizzando pinze ER

Preparazione



Bloccaggio e sbloccaggio della ghiera per pinze ER

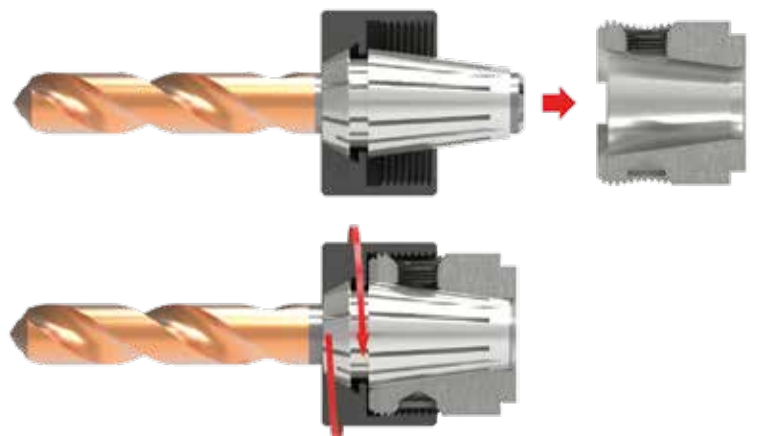



Bussola cilindrica

bussola cilindrica con piano.

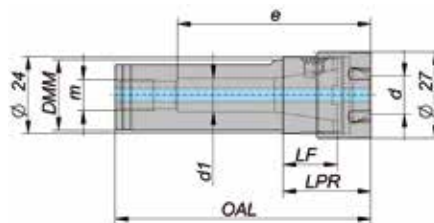
Per utilizzare sia le pinze ER che gli adattatori a cambio rapido nanoFlex® inserendo questa bussola in un portabareno.





Gran- dezza	Codice	DMM	d min.	d max.	LF	LPR	OAL	d ₁	m	e			
ER-16NF	NF16-SSH-075-A	¾"	0,5	10	17	28,5	78,5	10,5	G ¹ / ₈ "	60,5	NF16-SCN-A	107520005	NF16-SPLA
ER-16NF	NF16-SSH-022-A	22	0,5	10	17	28,5	80	10,5	G ¹ / ₈ "	60,5	NF16-SCN-A	107520005	NF16-SPLA
ER-16NF	NF16-SSH-025-A	25	0,5	10	17	28,5	78,5	10,5	G ¹ / ₈ "	60,5	NF16-SCN-A	107520005	NF16-SPLA

Dimensione in mm. Compresa ghiera e vite per ER-16 nanoFlex®.

Adattatore a cambio

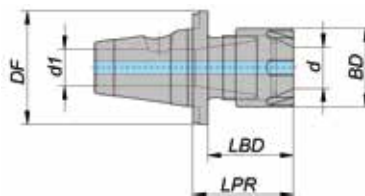
DIN 6499, ISO 15488





Gran- dezza	Codice	DF	d min.	d max.	d ₁	BD	LPR	LBD	Gran- dezza pinza		
ER-16NF	NF16-SAD-ER08-A	23	0,5	5	5,5	12	20,5	17,5	ER 8	200508000	107508005
ER-16NF	NF16-SAD-ER11-A	23	0,5	7	7,5	16	20,5	17,5	ER 11	200511000	107511005

Dimensione in mm

Adattatore Weldon/WhistleNotch

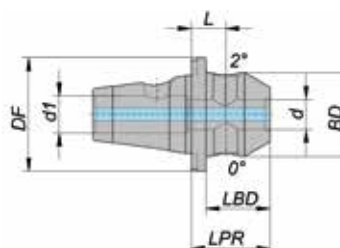
per utensili secondo norma DIN 6535-HB e HE



Gran- dezza	Codice	DF	d	BD	LPR	LBD	L	d ₁		
ER-16NF	NF16-SAD-WW06-A	23	6	17	16	13	7	7,5	12882	26071

Dimensione in mm

Master di controllo

per il Controllo e misura

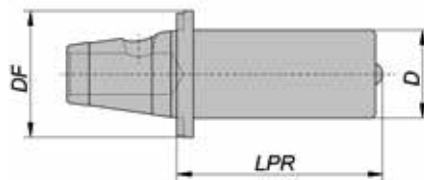





Gran- dezza	Codice	DF	D	LPR
ER-16NF	NF16-SMA-A	23	16	37,5

Dimensione in mm

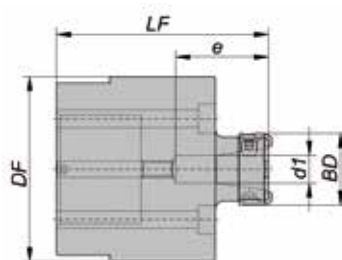
Dispositivo di montaggio e preset per gli adattatori a cambio rapido nanoFlex®

per il cambio degli utensili e presettaggio degli adattatori a cambio rapido nanoFlex®



Gran- dezza	Codice	DF	BD	LF	d ₁	e				
ER-16NF	NF16-SMD-A	70	27	80	10,5	35	NF16-STW-A	NF16-SDR-A	NF16-SCS-A	29205



Dimensione in mm

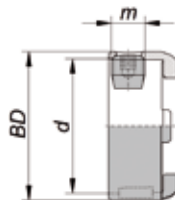

Anello di guida

per utilizzare gli adattatori a cambio rapido nanoFlex®



Gran-dezza	Codice	BD	d	m			
ER-16NF	NF16-SDR-A	27	24	M6x0,5	10IP	NF16-SCS-A	NF16-STW-A

Dimensione in mm. Vite di bloccaggio inclusa

Chiave dinamometrica

per il bloccaggio degli adattatori nanoFlex® con una mano sola



Nota:
Asta sostituibile

Gran-dezza	Codice		Nm	
ER-16NF	NF16-STW-A	10IP	2,5	109330

Dimensione in mm

Vite di bloccaggio ERNF

per il bloccaggio degli adattatori nanoFlex®



Gran-dezza	Codice		Nm	
ER-16NF	NF16-SCS-A	10IP	2,5	NF16-STW-A

Dimensione in mm

Ghiera per pinza ERNF

disponibile per mandrino nanoFlex®, DIN 6499, ISO 15488

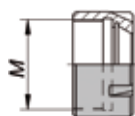



Gran-dezza	Codice	M	Nm	
ER-16NF	NF16-SCN-A	M24x1	45	107520005

Dimensione in mm

Tappo filettato ERNF

per tappare il foro filettato



Gran-dezza	Codice		Nm	
ER-16NF	NF16-SPL-A	10IP	2,5	NF16-STW-A

Dimensione in mm

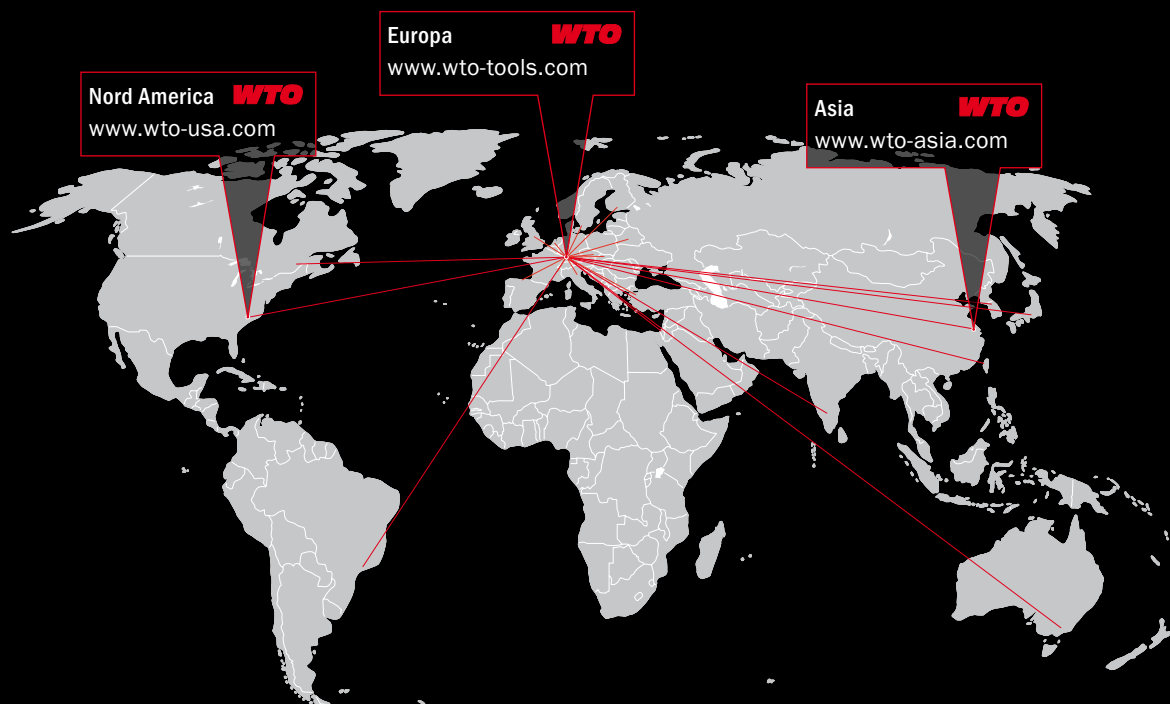

WTO
Werkzeug-
Einrichtungen GmbH
Neuer Hohdammweg 1
77797 Ohlsbach
Germania

WTO Inc.
13900-F South Lakes Dr.
Charlotte, NC 28273
Stati Uniti d'America

WTO Asia
WTO Precision Tool Holders
(Shanghai) Co. Ltd.
Room 109-110, Building 2
No. 228 Banting Road
Jiuting Town,
Songjiang District
201615 Shanghai
Cina

Our distribution partners. Competence right there.

Australia
Dimac Tooling Ltd.
sales@dimac.com.au

Brazil
TF2
tfdois@tfdois.com.br

Canada
Mittmann Industrial Inc.
info@mittmann.com

China
Shanghai Gangde
wtocando@yahoo.com

Czech Republic
ALBA precision, spol. s.r.o.
info@albaprecision.cz

Denmark
AVN Teknik A/S
cjo@avn.dk

Finland
Suomen Terätuonti Oy
myynti@stt.as

Francia, est
Christophe Archambault
alm@wto.de

Francia, ovest
Christophe Archambault
car@wto.de

Great Britain
Cutwel Ltd.
sales@cutwel.net

India
Ulhas Patil
u.patil@wto-asia.com

Israel
E.Y.A.R. Ltd.
boris@eyar.co.il

Italy
Prymark srl
commerciale@prymark.it

Japan
NK Works Co. Ltd.
k_samba@nk-works.co.jp

Korea
WTO Office Korea
is.chon@wto-korea.com

Messico
Workholding Engineering De México
info@wem.com.mx

Netherlands
Toologic BeNeLux B.V.
info@toologic-benelux.nl

Norway
Helge Karlsen Verktøy og Maskin AS
hkvm@hkvm.no

Polonia
ARCO Andrzej Rudenko
info@arcotools.pl

Romania
SC Elif Trading SRL
bulent.ozkan@eliftrading.com

Slowakia
ALBA precision s.r.o.
albaprecision@albaprecision.sk

Spain
ITALMATIC, S.A.
italmatic@italmatic.es

Sweden
Bonhron & Ewing AB
info@bonhron-ewing.se

Switzerland
Utilis AG
info@utilis.com

Taiwan
Kaiko Co., Ltd.
info@kaiko.com.tw

Turkey
MYK CNC MAKINA SAN. VE
huseyin.tatlidil@mykcnc.com.tr

Ukraine
„LLC“ SPA Stankopromimport
info@phoenix-ua.com

Ungheria
Prevotex Hungary Kft.
info@prevotex.hu